

Cab / Bed to Frame Mounting Hardware (as Original) / Radiator Core Support

Chevrolet Truck 1973-80
 GMC Truck 1973-80
 Chevrolet Crew Cab 1973-80
 GMC Truck Crew Cab 1973-80

Fleetside Complete Mounting Kit

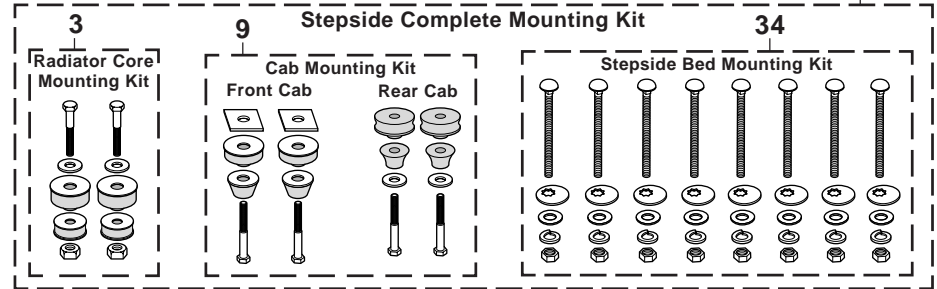
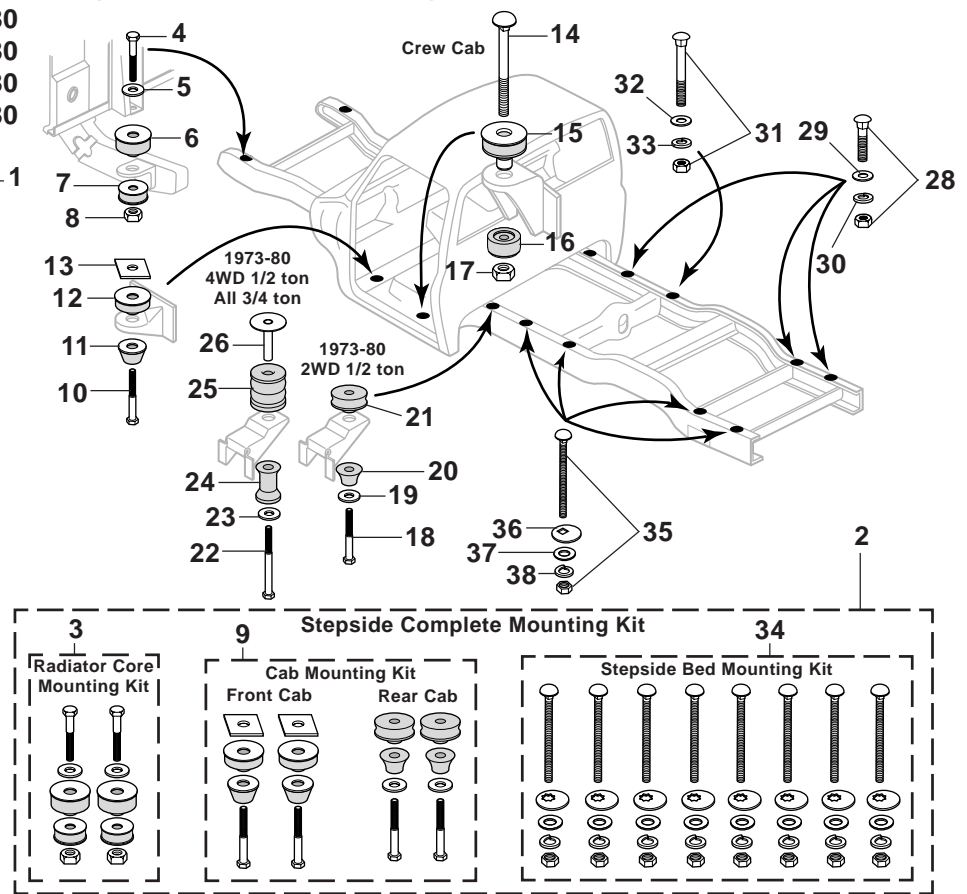
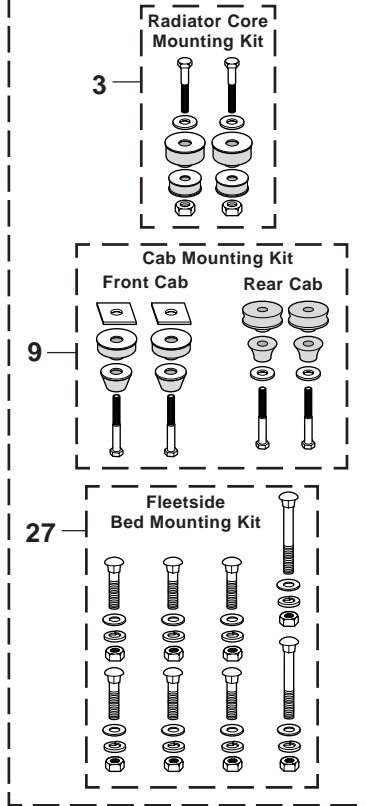

One kit does the job! The complete mounting kit includes the Radiator Core Support Mounting Kit, Front and Rear Cab to Frame Mounting Kit and the Bed to Frame Mounting Kit. These rubber cushions are made exactly like the originals from the factory. Installing new cushions will help return your truck to its original smooth ride. Replace your rusted, corroded hardware for safety and security. This kit does it all and saves you money! Call or go online and order yours today!

Fleetside Complete Mounting Kit

30-0143	(1) COMPLETE MOUNTING KIT 58PC FLEETSIDE RAD CORE/CAB/BED TO FRAME 2WD 1/2T	73-80 (1)	149.94	119.95
30-0145	COMPLETE MOUNTING KIT 60PC STD CAB RAD CORE/CAB/BED TO FRAME 2WD 3/4T	73-80 (1)	149.94	119.95
30-0147	COMPLETE MOUNTING KIT 60PC FLEETSIDE RAD CORE/CAB/BED TO FRAME 4WD	73-80 (1)	149.94	119.95
30-1161	COMPLETE MOUNTING KIT 68PC RAD CORE/CAB/BED TO FRAME CREW CAB	73-80 (1)	187.44	149.95

Stepside Complete Mounting Kit

30-0578	(2) COMPLETE MOUNTING KIT 66PC STEPSIDE RAD CORE/CAB/BED TO FRAME 2WD 1/2T	73-80 (1)	174.94	139.95
30-0579	COMPLETE MOUNTING KIT 68PC STEPSIDE RAD CORE/CAB/BED TO FRAME 2WD 3/4T	73-80 (1)	174.94	139.95
30-0580	COMPLETE MOUNTING KIT 68PC STEPSIDE RAD CORE/CAB/BED TO FRAME 4WD	73-80 (1)	174.94	139.95

Radiator Core Support Mounting Kit - Fleetside/Stepside

30-0148	(3) RAD CORE MOUNTING KIT 10PC 2WD	73-80 (1)	62.44	49.95
30-0159	RAD CORE MOUNTING KIT 10PC 4WD	73-80 (1)	74.94	59.95
30-0320	(4) HEX BOLT	CHEVY GMC 73-80 (2)	2.44	1.95
30-0685	(5) FLAT WASHER	CHEVY GMC 73-80 (2)	.50	.40
30-2024	(6) UPPER CUSHION-CORE MOUNT	2WD 73-80 (2)	24.94	19.95
30-2028	UPPER CUSHION-CORE MOUNT	4WD 73-80 (2)	24.94	19.95
30-2031	(7) LOWER CUSHION-CORE MOUNT	2WD 73-80 (2)	18.69	14.95
30-2033	LOWER CUSHION-CORE MOUNT	4WD 73-80 (2)	18.69	14.95
30-0808	(8) TORQUE LOCK NUT	CHEVY GMC 73-80 (2)	1.19	.95

Cab to Frame Mounting Kit - Fleetside/Stepside

30-0157	(9) CAB MOUNTING KIT 16PC 2WD 1/2T	73-80 (1)	124.94	99.95
30-0158	CAB MOUNTING KIT 18PC 4WD 1/2T	73-80 (1)	174.94	139.95
30-0158	CAB MOUNTING KIT 18PC 3/4T	73-80 (1)	174.94	139.95
30-1164	CAB MOUNTING KIT 26PC CREW CAB	73-80 (1)	199.94	159.95
30-0205	(10) HEX BOLT	CHEVY GMC 73-80 (2)	2.44	1.95
30-2032	(11) LOWER CUSHION-CAB MOUNT	CHEVY GMC 73-80 (2)	18.69	14.95
30-2030	(12) UPPER CUSHION-CAB MOUNT	CHEVY GMC 73-80 (2)	24.94	19.95
30-2830	(13) SHIM	CHEVY GMC 73-80 (2)	7.44	5.95
30-0964	(14) HEX BOLT	CREW CAB 73-80 (2)	8.69	6.95
30-2043	(15) UPPER CUSHION-CAB MOUNT	CREW CAB 73-80 (2)	24.94	19.95
30-2031	(16) LOWER CUSHION-CAB MOUNT	CREW CAB 73-80 (2)	18.69	14.95
30-0808	(17) TORQUE LOCK NUT	CREW CAB 73-80 (2)	1.19	.95
30-0205	(18) HEX BOLT	2WD 1/2T 73-80 (2)	2.44	1.95
30-0684	(19) FLAT WASHER	2WD 1/2T 73-80 (2)	2.44	1.95
30-2036	(20) LOWER CUSHION-CAB MOUNT	2WD 1/2T 73-80 (2)	12.44	9.95
30-2034	(21) UPPER CUSHION-CAB MOUNT	2WD 1/2T 73-80 (2)	18.69	14.95
30-0278	(22) HEX BOLT	4WD 1/2T ALL 3/4T 73-80 (2)	9.94	7.95
30-0684	(23) FLAT WASHER	4WD 1/2T ALL 3/4T 73-80 (2)	2.44	1.95
30-2042	(24) LOWER CUSHION	4WD 1/2T ALL 3/4T 73-80 (2)	16.19	12.95
30-2040	(25) UPPER CUSHION	4WD 1/2T ALL 3/4T 73-80 (2)	24.94	19.95
30-2955	(26) SPACER	4WD 1/2T ALL 3/4T 73-80 (2)	24.94	19.95

Fleetside Bed to Frame Mounting Kit

30-0120	(27) BED MOUNT HARDWARE KIT 32PC FLEETSIDE	73-80 (1)	37.44	29.95
30-0246	(28) BED MOUNT BOLT W/NUT	FLEETSIDE 73-80 (6)	6.19	4.95
30-0676	(29) FLAT WASHER	FLEETSIDE 73-80 (6)	.38	.30
30-0680	(30) LOCK WASHER	FLEETSIDE 73-80 (6)	.56	.45
30-0350	(31) BODY HOLD DOWN BOLT W/NUT	FLEETSIDE 73-80 (2)	8.69	6.95
30-0676	(32) FLAT WASHER	FLEETSIDE 73-80 (2)	.38	.30
30-0680	(33) LOCK WASHER	FLEETSIDE 73-80 (2)	.56	.45

Stepside Bed to Frame Mounting Kit

30-0144	(34) BED MOUNT BOLT KIT-STL 40PC STEPSIDE	73-80 (1)	24.94	19.95
30-0138	BED MOUNT BOLT KIT-SS 40PC STEPSIDE	73-80 (1)	49.94	39.95
30-0292	(35) CARRIAGE BOLT W/NUT	STEPSIDE 73-80 (8)	2.44	1.95
30-0645	(36) OFFSET WASHER	STEPSIDE 73-80 (8)	3.69	2.95
30-0705	(37) FLAT WASHER	STEPSIDE 73-80 (8)	.81	.65
30-0628	(38) LOCK WASHER	STEPSIDE 73-80 (8)	.44	.35